

Harvest Rise

Hilperton, Trowbridge, Wiltshire



2 two-bedroom houses and 1 three-bedroom house for sale on a New Build HomeBuy basis (shared ownership).



Available from April 2008

Plots available: No. 116,117, 118.

These houses are located on the Persimmon Homes development in Hilperton, Trowbridge. They have good access to local schools and shops, the nearest train station is just over one mile away in Trowbridge town centre.

Applicants are required to be registered with West Wiltshire Council on their housing waiting list and have a local connection to the area (e.g. live or work within West Wiltshire).

Specification

These properties benefit from Buildmark Choice, which is a 10-year warranty and insurance cover from the National House Building Council (NHBC)

Kitchen:

- Fully-fitted kitchen
 - Oven, hob and extractor hood
-

Living room:

- BT point
 - Television point
-

Bathroom:

- Shower fitted over bath
 - White bathroom suite
-

Heating:

- Gas central heating
-

Outside:

- Turfed rear gardens

These particulars do not constitute any part of an offer or contract and any intending purchaser must make their own enquiries as to the accuracy of any representations contained herein. Somer Housing Group does not guarantee the accuracy of any representations contained herein and reserves the right to amend or alter the particulars of the properties or this brochure at any time before contracts for sales with any purchaser are concluded.

Site plan

Site Plan

Important Notice
 The site layout is intended for illustrative purposes only and may change, for example, in response to market demand or ground conditions. It should be treated as general guidance and cannot be relied upon as accurately describing any one of the Specified matters prescribed by any order made under Property misdescriptions act 1991. Landscaping is indicative. Please refer to the Landscape Plan available from the site Sales Adviser.

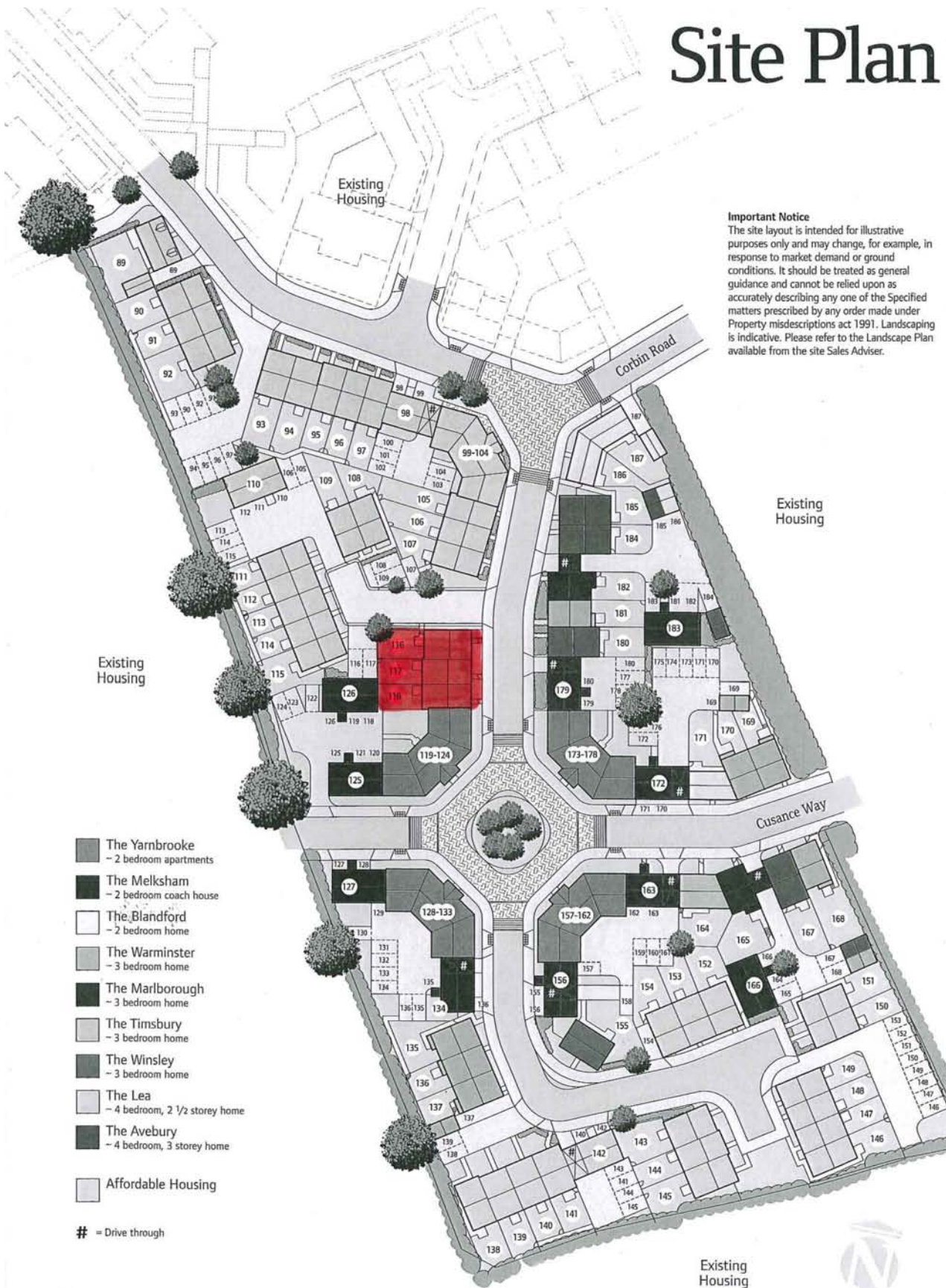

- The Yarnbrooke
- 2 bedroom apartments
- The Melksham
- 2 bedroom coach house
- The Blandford
- 2 bedroom home
- The Warminster
- 3 bedroom home
- The Marlborough
- 3 bedroom home
- The Tisbury
- 3 bedroom home
- The Winsley
- 3 bedroom home
- The Lea
- 4 bedroom, 2 1/2 storey home
- The Avebury
- 4 bedroom, 3 storey home
- Affordable Housing
- # = Drive through

Harvest Rise
Trowbridge



These particulars do not constitute any part of an offer or contract and any intending purchaser must make their own enquiries as to the accuracy of any representations contained herein. Somer Housing Group does not guarantee the accuracy of any representations contained herein and reserves the right to amend or alter the particulars of the properties or this brochure at any time before contracts for sales with any purchaser are concluded.

Energy Ratings

Plot 116

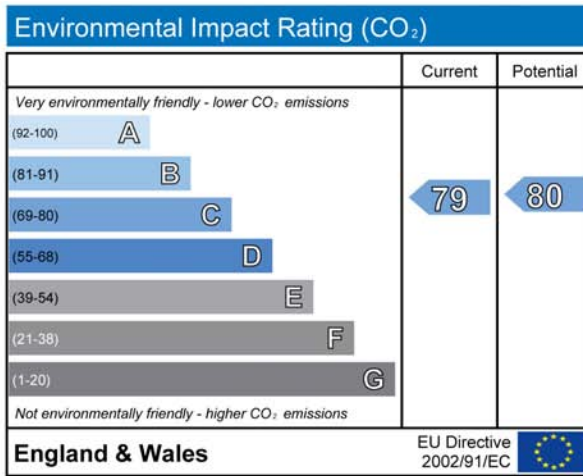
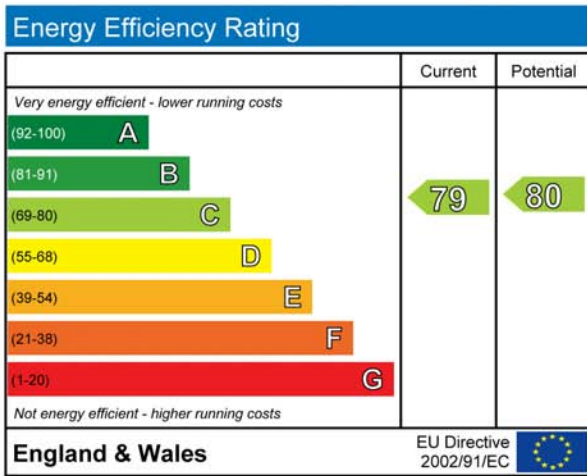

Plot 117

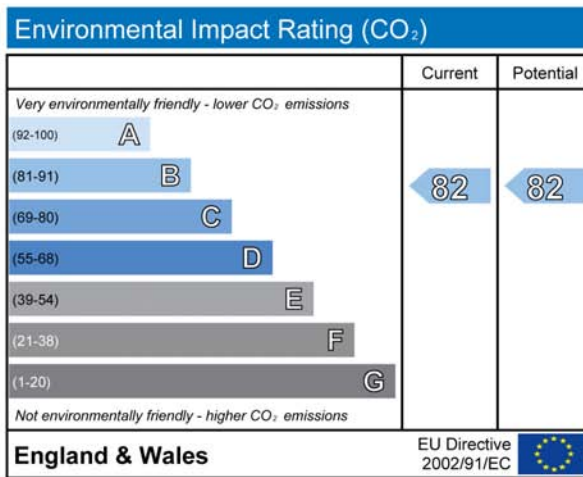
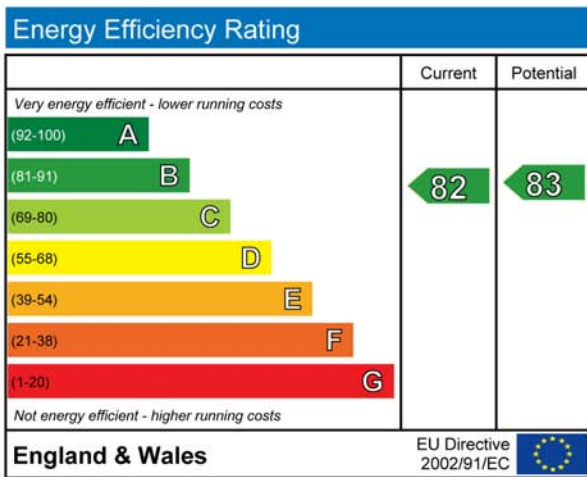

Plot 118

